

MAX. DOOR HEIGHT
ALUMAVIEW OPTIMA = 20' - 0"
STYLEVIEW WIDE PROFILE = 10' - 0"
STYLEVIEW CUSTOM PROFILE = 10' - 0"

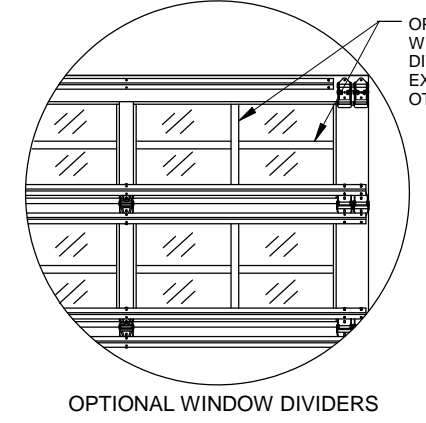
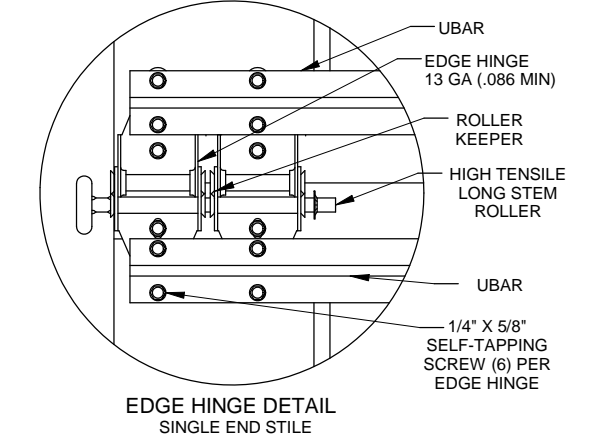
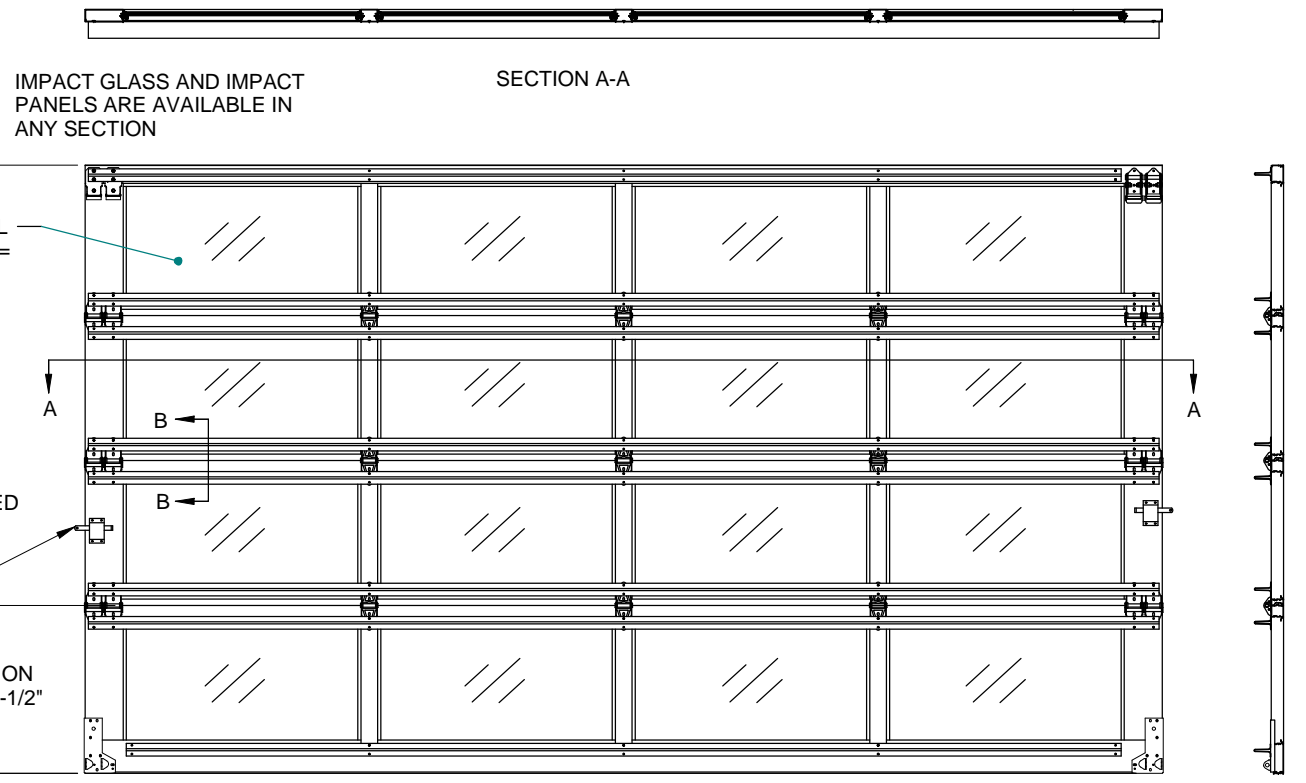

INTERIOR ELEVATION
TRACK AND COUNTER BALANCE ASSEMBLIES WERE OMITTED FROM ALL DETAILS ON THIS PAGE FOR CLARITY. SEE SHEET 3 FOR TRACK AND COUNTER BALANCE DETAILS

DOORS TESTED PER ANSI/DASMA 108 FOR STATIC AIR PRESSURE

TESTED PER TAS 201 AND TAS 203 AND ANSI/DASMA 115 FOR LARGE MISSILE IMPACT AND CYCLIC WIND PRESSURE

MAXIMUM DOOR WIDTH	DESIGN LOAD	
14' - 2"	+ 43.0	- 48.0

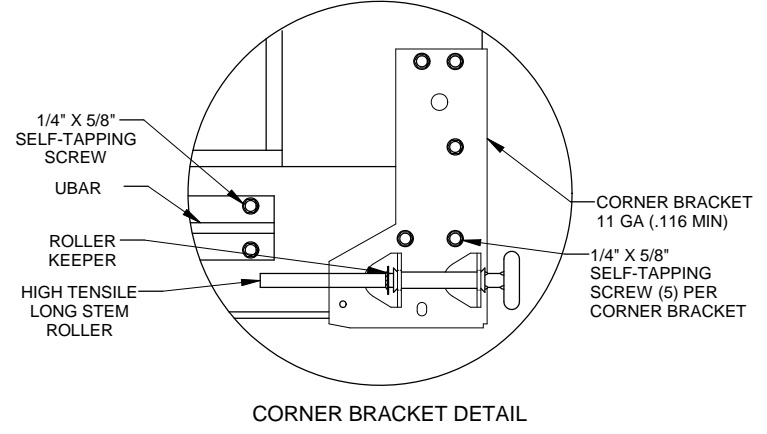

LARGE MISSILE IMPACT RESISTANT

Scott A. Brown P.E.
F.P.E #65940
698 Timber Creek Road
Dixon Illinois 61021

SCALE: NONE		DRAWN BY: G.WEDEKIND		TITLE: SPEC, WIND LOAD ALUMAVIEW AND STYLEVIEW	
B	1) WAS RICHARD A BAUMANN, P.E., 2) UPDATED JAMB ATTACHMENTS	7804.01	10/02/17	CHECKED BY: GW	RAYNOR GARAGE DOORS BOX 448 EAST RIVER ROAD DIXON, ILL. 61021
A	RELEASED FOR PRODUCTION	6338.01	06/14/12	DATE: 06/14/12	
REV.	DESCRIPTION	ECN. NO.	DATE	ECN. NO.: 6338.01	NO. P-3327
					SHEET 1 OF 4
					REV B

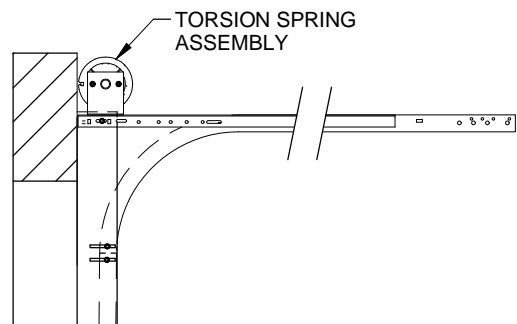

NORMAL HEADROOM TRACK
2" TRACK ANGLE MOUNT SHOWN
2" TRACK BRACKET MOUNT AVAILABLE
3" TRACK ANGLE MOUNT AVAILABLE

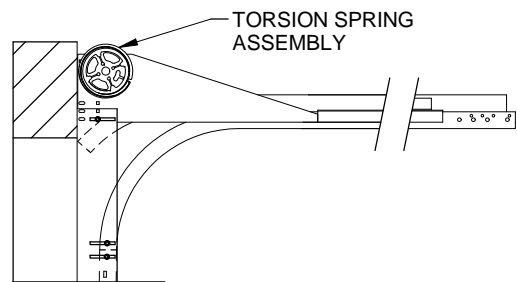

FRONT MOUNT LOW HEADROOM TRACK
2" TRACK ANGLE MOUNT SHOWN
2" TRACK BRACKET MOUNT AVAILABLE
3" TRACK ANGLE MOUNT AVAILABLE

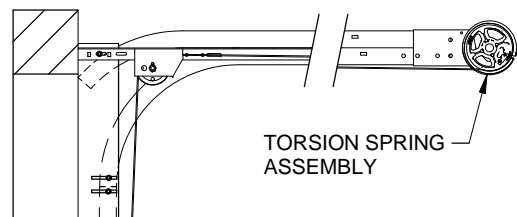

REAR MOUNT LOW HEADROOM TRACK
2" TRACK ANGLE MOUNT SHOWN
2" TRACK BRACKET MOUNT AVAILABLE
3" TRACK ANGLE MOUNT AVAILABLE

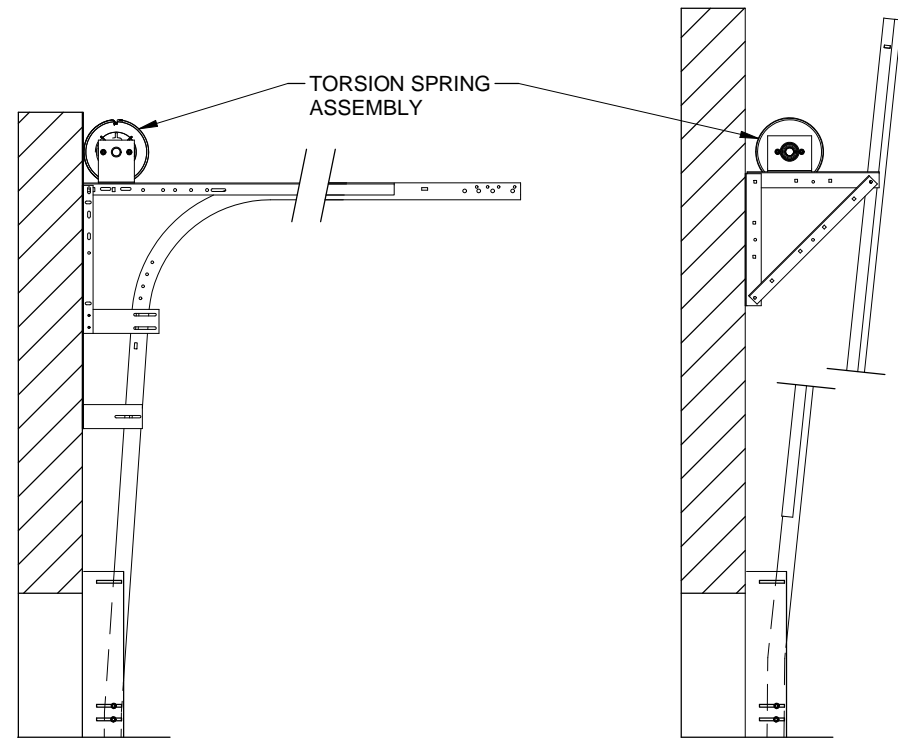

LIFT CLEARANCE TRACK
2" TRACK ANGLE MOUNT SHOWN
2" TRACK BRACKET MOUNT AVAILABLE
3" TRACK ANGLE MOUNT AVAILABLE

VERTICAL LIFT TRACK
2" TRACK ANGLE MOUNT SHOWN
2" TRACK BRACKET MOUNT AVAILABLE
3" TRACK ANGLE MOUNT AVAILABLE

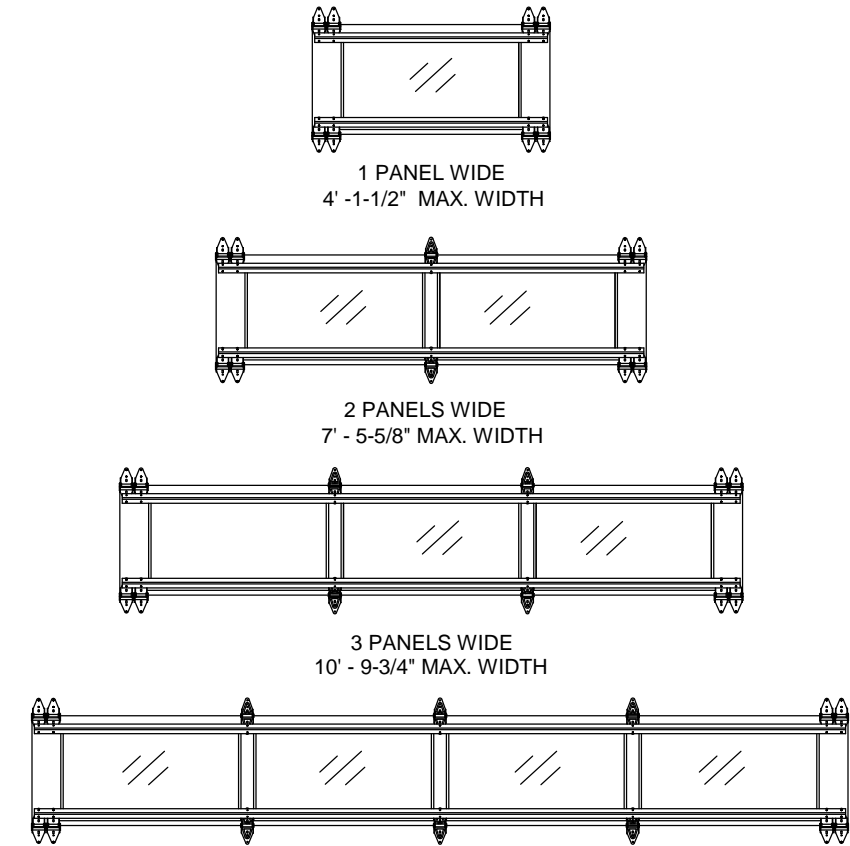

1 PANEL WIDE
4' - 1-1/2" MAX. WIDTH

2 PANELS WIDE
7' - 5-5/8" MAX. WIDTH

3 PANELS WIDE
10' - 9-3/4" MAX. WIDTH

4 PANELS WIDE
14' - 2" MAX. WIDTH

CENTER STILE AND PANEL LAYOUT
INTERIOR VIEW
INTERMEDIATE SECTION SHOWN

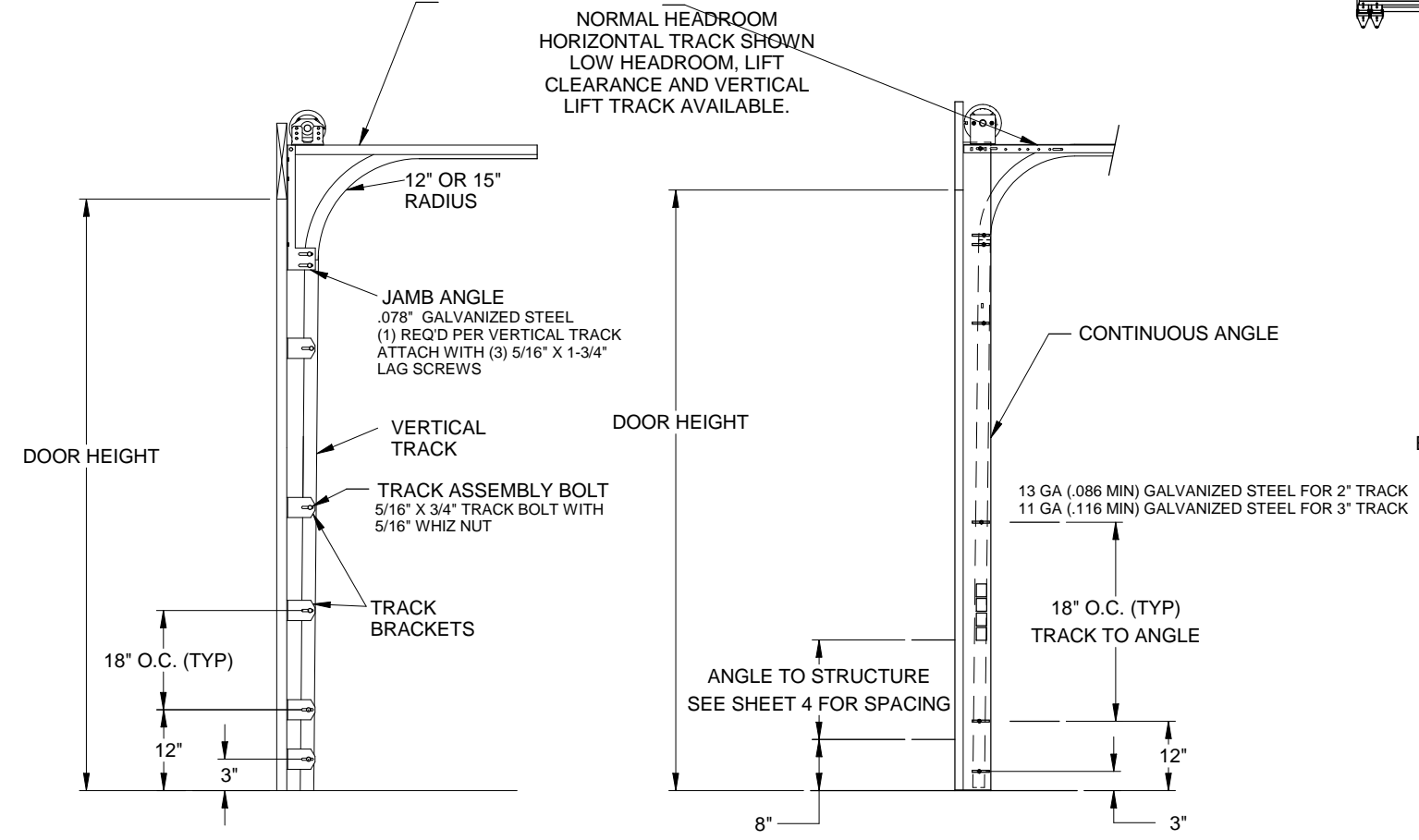

TYPICAL TRACK INSTALLATION
BRACKET MOUNT
WOOD JAMBS

TYPICAL TRACK INSTALLATION
ANGLE MOUNT
WOOD, STEEL OR MASONRY
JAMBS

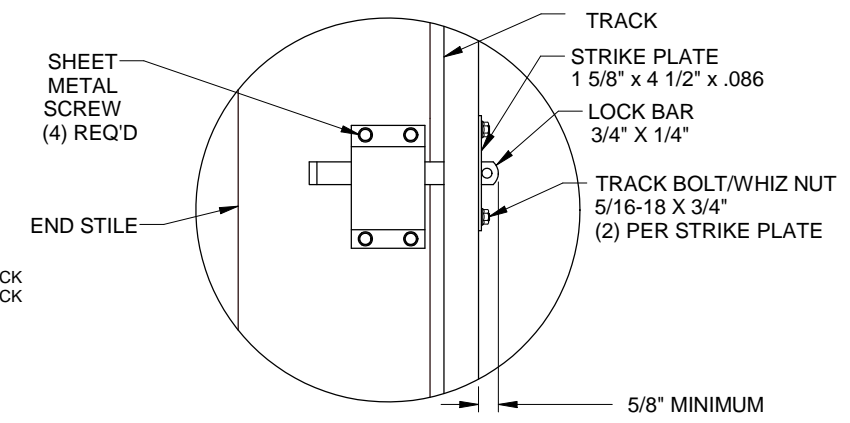

OPTIONAL INTERIOR
LOCK DETAIL

Scott A. Brown P.E.
F.P.E #65940
698 Timber Creek Road
Dixon Illinois 61021

SCALE: NONE	 80X 488 EAST RIVER ROAD DIXON, ILL. 61021	TITLE: SPEC, WIND LOAD ALUMAVIEW AND STYLEVIEW
DRAWN BY: G.WEDEKIND		NO. P-3327
CHECKED BY: GW		
DATE: 06/14/12		REV B
ECN NO. 6338.01	DESCRIPTION	DATE

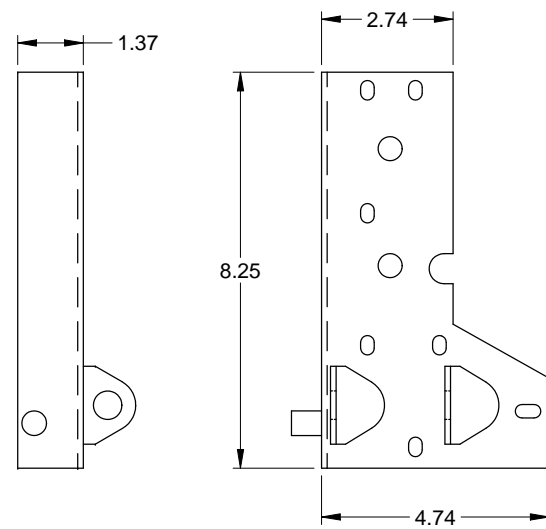

SCALE 1:2
CORNER BRACKET
(FOR DOORS OVER 600 LBS)
.116 GALV. STEEL

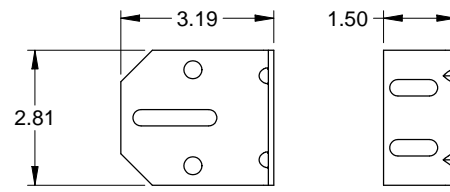

SCALE 1:2
3" TRACK BRACKET
.116 GALV. STEEL

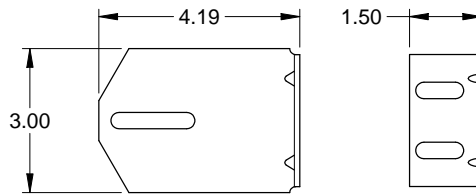

SCALE 1:2
4" TRACK BRACKET
.116 GALV. STEEL

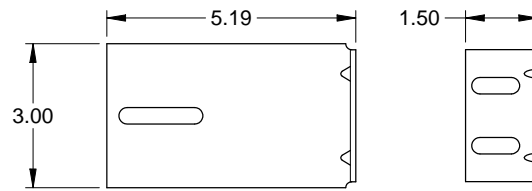

SCALE 1:2
5" TRACK BRACKET
.116 GALV. STEEL

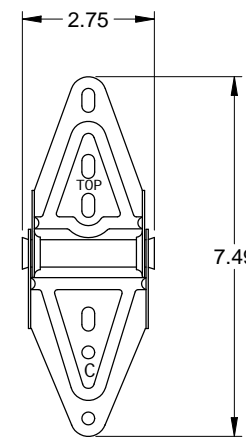

SCALE 1:2
CENTER HINGE
.045 GALV. STEEL

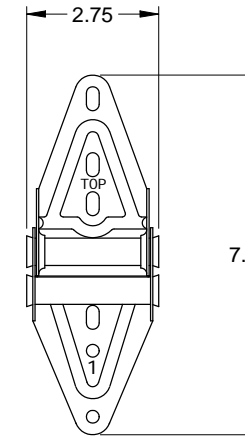

SCALE 1:2
EDGE HINGE
.086 GALV. STEEL

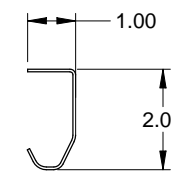

SCALE 1:2
2" TRACK
.086 MIN. GALV. STEEL

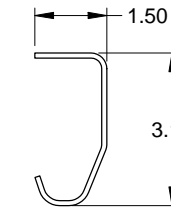

SCALE 1:2
3" TRACK (OPTIONAL)
.105 GALV. STEEL

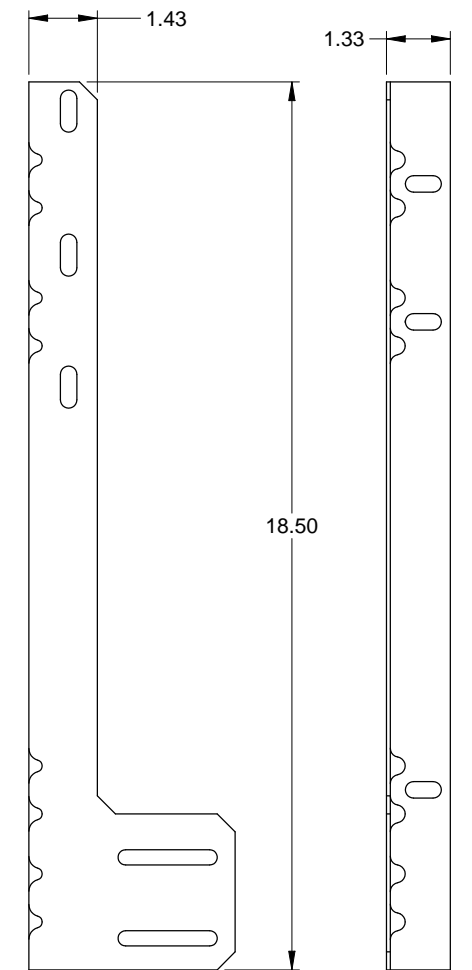

SCALE 1:2
JAMB ANGLE
.078 GALV. STEEL

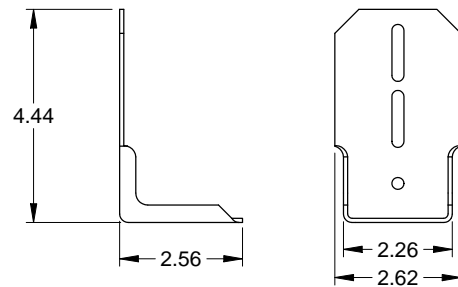

SCALE 1:2
LIGHT COMMERCIAL TOP FIXTURE
(FOR DOORS 5 SECTIONS HIGH OR LESS)
.086 GALV. STEEL

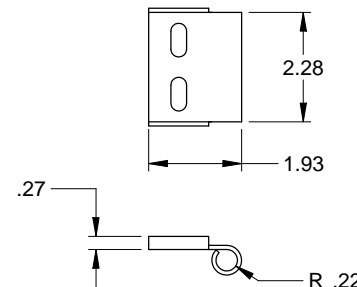

SCALE 1:2
ROLLER CARRIER
.116 GALV. STEEL
ATTACHED TO LIGHT COMMERCIAL TOP FIXTURE
WITH (2) TRACK BOLTS AND WHIZ NUTS

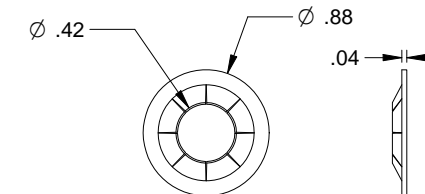

RETAINING NUT

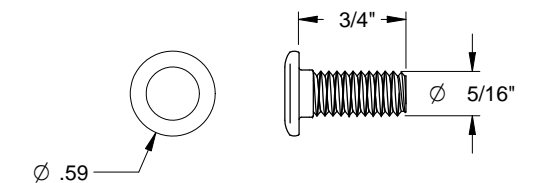

TRACK BOLT

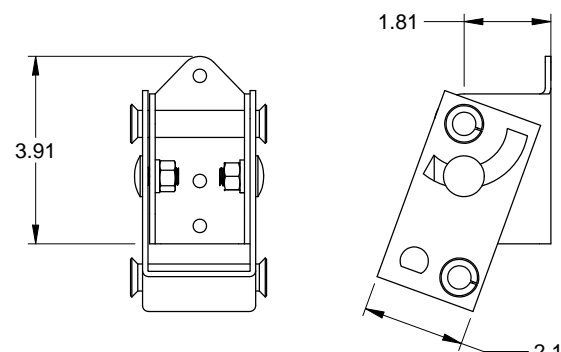

SCALE 1:2
HEAVY COMMERCIAL TOP FIXTURE
.116 GALV. STEEL

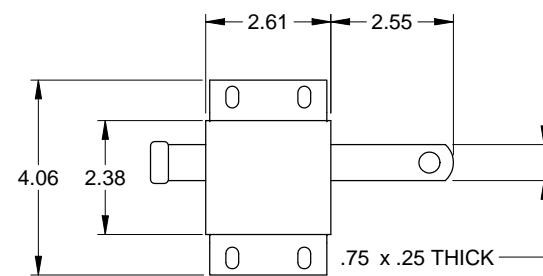

SCALE 1:
SLIDE LOCK (OPTIONAL)
CASE .086 GALV. STEEL

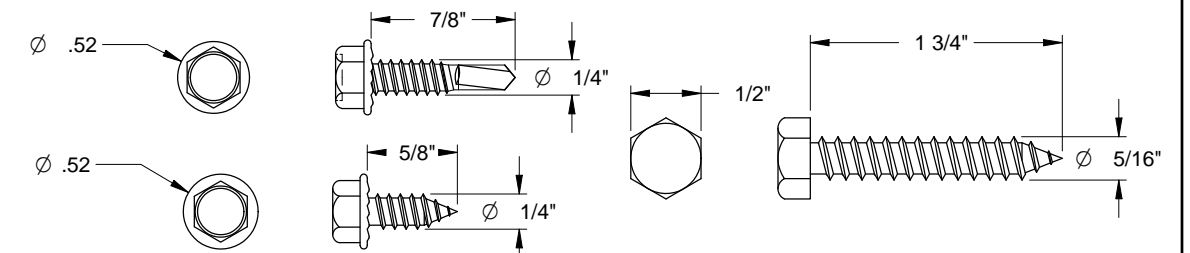

SHEET METAL SCREW
BOTH STYLES ARE INTERCHANGABLE

HEX HEAD LAG SCREW

SCALE: NONE		DRAWN BY: G.WEDEKIND		TITLE: SPEC, WIND LOAD ALUMAVIEW AND STYLEVIEW	
CHECKED BY: GW		DATE: 06/14/12		NO. P-3327	
ECN NO.		DATE		SHEET 3 OF 4	
REV.		DESCRIPTION		REV B	

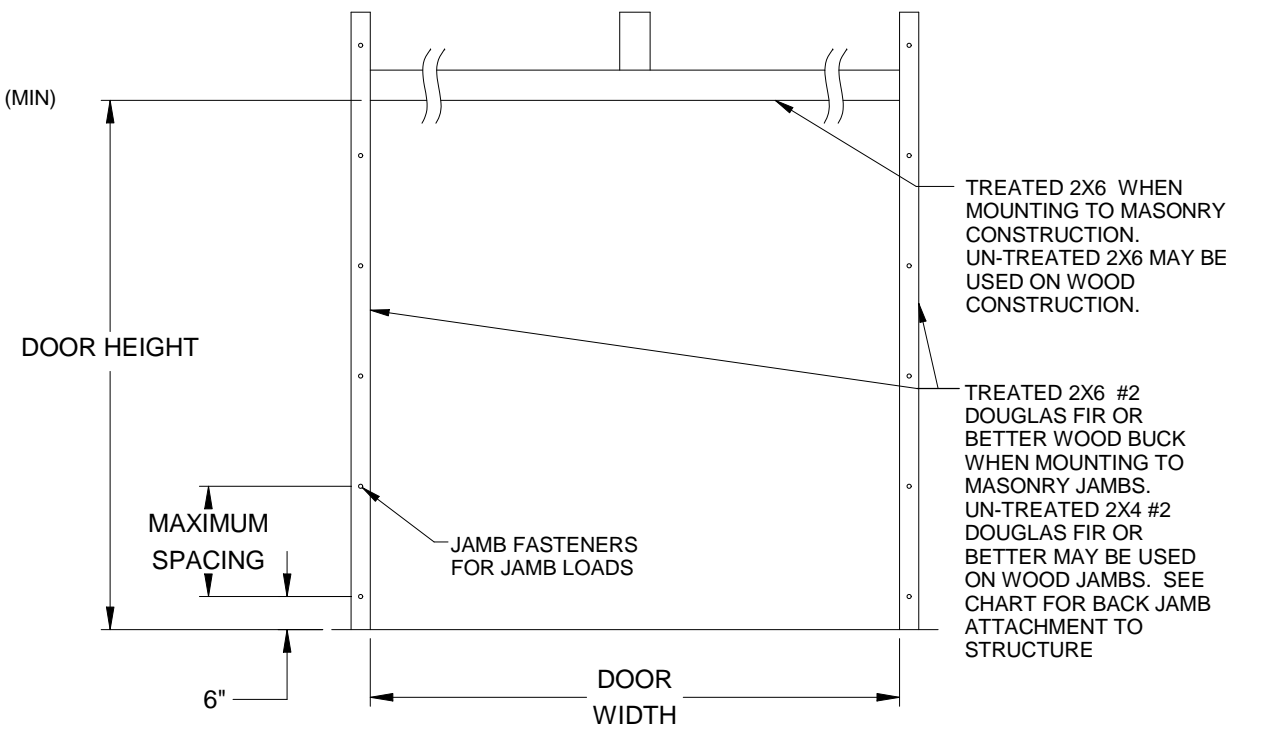
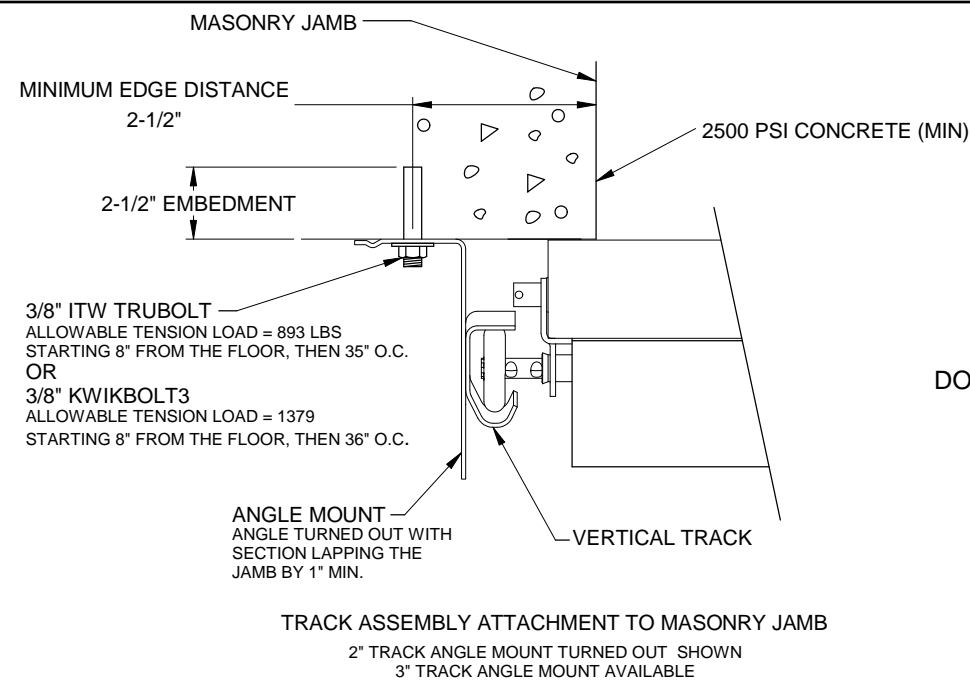
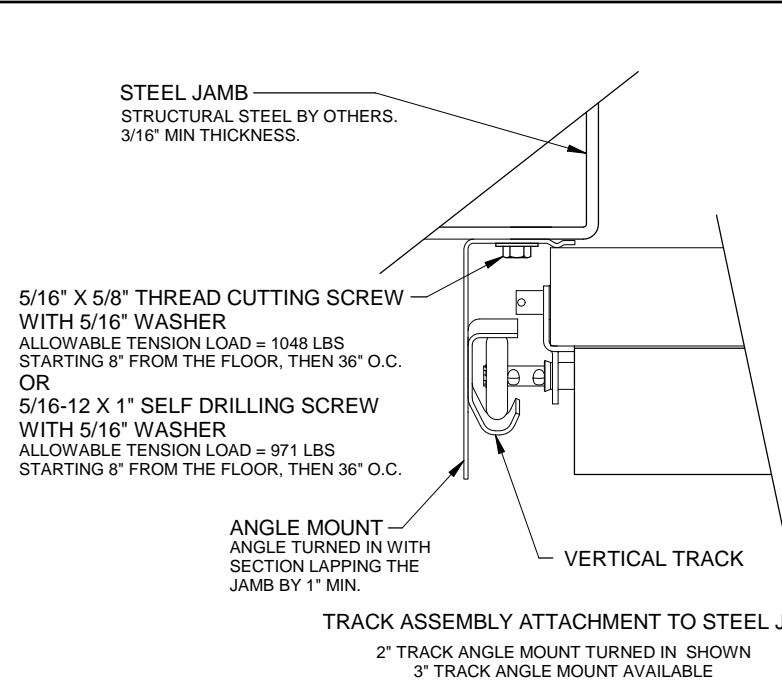

JAMB ATTACHMENT

JAMB ATTACHMENT NOTES

1. MAXIMUM POSITIVE LOAD PER JAMB = (14'-2" X 43.0 PSF) / 2 = 305 LBS PER FOOT
2. MAXIMUM NEGATIVE LOAD PER JAMB = (14'-2" X -48.0 PSF) / 2 = 340 LBS PER FOOT.
3. DESIGN OF THE SUPPORTING STRUCTURE SHALL BE THE SOLE RESPONSIBILITY OF THE BUILDING DESIGNER AND SHALL BE DESIGNED FOR THE JAMB LOADS LISTED IN NOTES 1 AND 2.
4. ALTERNATE JAMB ATTACHMENTS MAY BE USED IF APPROVED BY A REGISTERED PROFESSIONAL ENGINEER.
5. DASMA TECHNICAL DATA SHEET TDS-161 MAY BE USED FOR ALTERNATE JAMB ATTACHMENTS.
6. 3/8" DIAMETER LAG SCREWS REQUIRE 1/16" DIAMETER PILOT HOLE AND 1-1/2" MINIMUM EDGE DISTANCE.

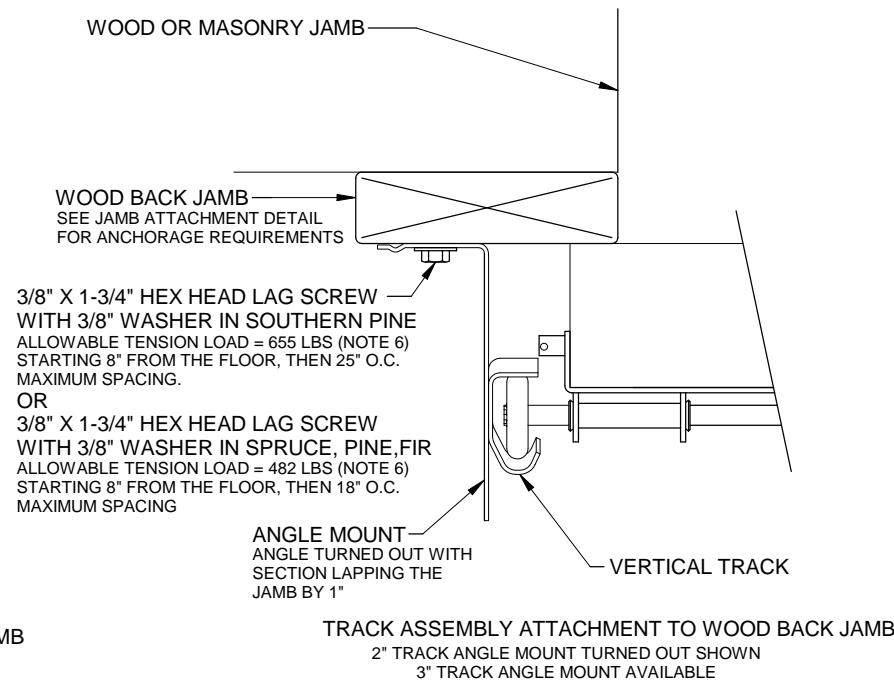
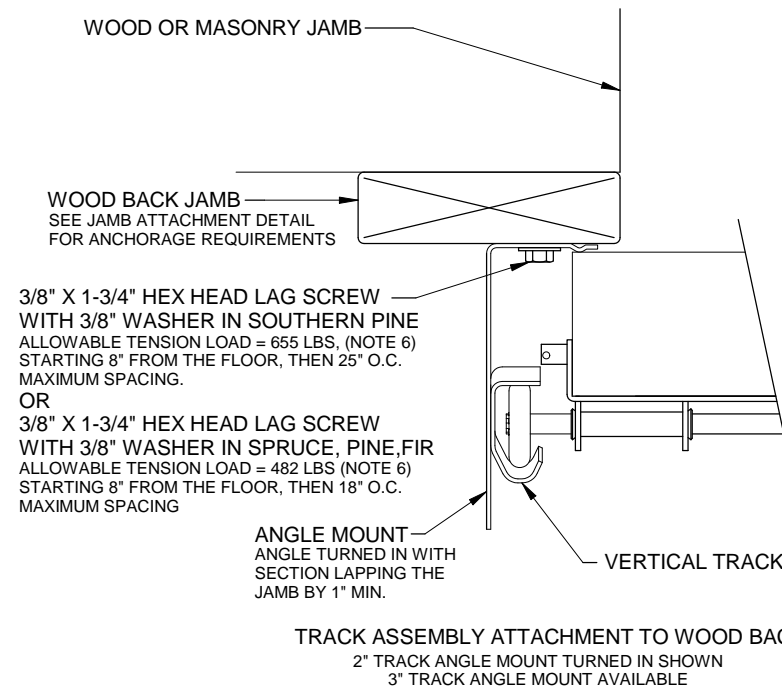

2X6 ATTACHMENT TO STRUCTURE						
STRUCTURE TYPE	FASTENER TYPE	MINIMUM EMBEDMENT	MINIMUM EDGE DISTANCE	MINIMUM ON CENTER SPACING	DIMENSION A (MAXIMUM ON CENTER SPACING)	ALLOWABLE TENSION LOAD
2500 PSI MIN. CONCRETE	1/4" TAPCON+ (PLUS) WITH 1-1/8" OD WASHER	2"	2.5	6"	24"	691
SOUTHERN PINE	3/8" X 3" LAG WITH 1-1/8" OD WASHER	1.50"	1.50"	1.50"	24"	655
SPRUCE PINE FIR	3/8" X 3" LAG WITH 1-1/8" OD WASHER	1.50"	1.50"	1.50"	18"	482